

ABLOY® PROTEC²

Europrofile DIN cylinders



ABLOY

ABLOY® PROTEC²

DIN Europrofile door cylinders are used in lock cases conforming to DIN Standard 18251.

SINGLE CYLINDERS

CY321T (31), CY331T (32)
CY326T (36), CY336T (37)

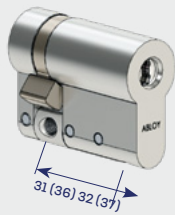

DOUBLE CYLINDERS

CY322T (31), CY332T (32)
CY327T (36), CY337T (37)

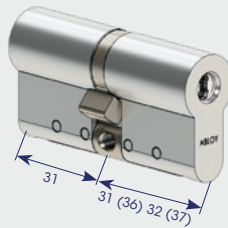

CYLINDER WITH THUMBTURN

CY323T (31), CY333T (32)
CY328T (36), CY338T (37)

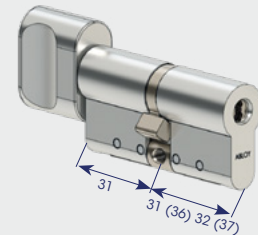

SECURITY CYLINDER RINGS

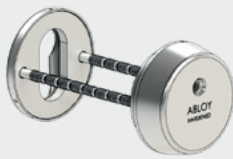

CH101 for wooden doors



CH102 for narrow stile doors

EXTENSION PIECE SYSTEM:

The modular extension piece system enables easy adjustment of the cylinder length even during installation. Cylinder length is adjustable in 5mm increments up to 50mm extension and in 10mm increments up to 100mm extension.

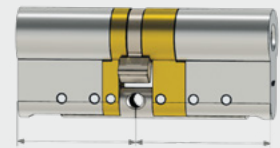

CAMS:

808050
Cam 9mm

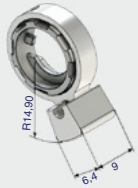

808810
Cam 7,5mm

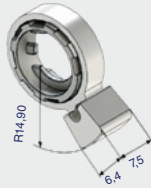

812264
Cam thin

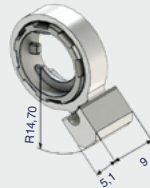

814037 *)
Lazy cam

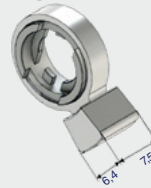

814823 **) Gear cam with 10 teeth

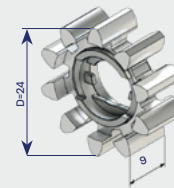

812504 **) Gear cam with 10 teeth

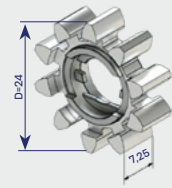

CAM POSITION:

Easily adjustable cam enables eight different cam positions to allow different lock case functions.

*) 120° free movement

**) Options: Solid or 35° free movement

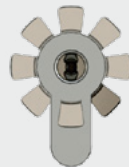

CONSTRUCTION

Cylinder housing
Cylinder housing

Cylinder drum
Discs and washers
Number of discs

CY320 series Brass
CY330 series exterior housings
Case Hardened Steel
Brass
Tin bronze
11

FINISHES AVAILABLE



BRIGHT CHROME



SATIN CHROME



BRUSHED NICKEL

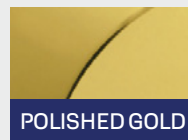

POLISHED GOLD



BRUSHED GOLD

ABLOY offers security and locking innovations dedicated to creating more trust in the world. Combining digital and mechanical expertise, Abloy Oy develops industry-leading security solutions that protect people, property and business. Abloy is part of the ASSA ABLOY Group, the global leader in access solutions. Every day, we help billions of people experience a more open world.

ABLOY UK
Portobello Works
School Street
WV13 3PW
England
Tel. 01902 364500
www.abloy.co.uk
info@abloy.co.uk

Abloy maintains Product Security Center at www.abloy.com/securitycenter. We recommend that you check the Center on a regular basis in order to be fully informed of product security updates, so that your knowledge of our products remains optimal.

It is the customer's responsibility to define the required level of security, whilst taking into consideration relevant factors for its operations. To achieve the overall level of security required in the customer's operations multiple layers of security must be in place. These include for example locking system, key management system, access management, CCTV and alarm system as well as physical security in a manner and level specified by the customer.

This content is protected by Intellectual Property Rights Laws. The title to the content shall not pass to you, and instead shall remain with Abloy Oy or a third party holding the title. Abloy develops continuously the products and solutions offered. Therefore, the information contained in the document is subject to change without notice. ABLOY PROVIDES THIS CONTENT ON AN "AS IS" BASIS WITHOUT ANY WARRANTIES OF ANY KIND EXPRESS, IMPLIED, OR STATUTORY."



8807743 | 09/2024